

Kubelki (czerpaki) z tworzywa

- poliamidowe (PA)
- polietylenowe zwykłe (PE HDP)
- poliuretanowe (PU)

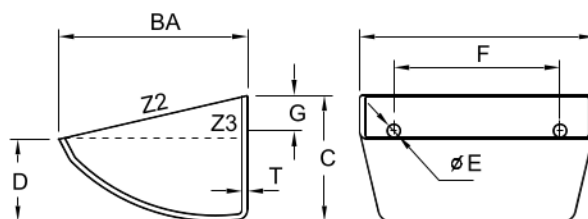

Typ - MS



No.	A (mm)	B (mm)	C (mm)	D (mm)	T (mm)	kg	Pojemność (litry)		Średnica otworu			max. pcs/m	
							Z2 (total)	Z3	No.	E (ø mm)	F (mm)		G (mm)
MS100-90HDP-MD	109	90	62	39	4.0	0.06	0.35	0.23	2	8.5	50	17	14.2
MS130-120HDP-MD	140	121	81	54	4.7	0.13	0.70	0.50	2	8.5	70	22	11.1
MS180-140HDP-MD	190	148	94	55	5.5	0.21	1.30	0.88	2	8.5	100	30	10.5
MS230-170HDP-MD	240	175	111	70	5.5	0.36	2.50	1.85	2	11.0	120	38	9
MS280-170HDP-MD	290	173	111	75	6.0	0.45	3.00	2.28	3	11.0	80	38	9

No.	A (mm)	B (mm)	C (mm)	D (mm)	T (mm)	kg	Pojemność (litry)		Średnica otworu			max. pcs/m	
							Z2 (total)	Z3	No.	E (ø mm)	F (mm)		G (mm)
MS150-110HDP	159	113	78	51	5.2	0.17	0.72	0.49	2	9.0	89	24	12
MS180-140HDP	190	146	94	56	6.0	0.22	1.30	0.97	2	9.0	100	30	10.5
MS225-140HDP	235	140	94	60	6.0	0.34	1.67	1.16	2	9.0	120	30	10.5
MS230-170HDP	240	173	110	70	6.0	0.43	2.32	1.75	2	11.0	120	38	9
MS280-170HDP	290	173	113	72	6.0	0.50	3.00	2.28	3	11.0	80	38	9
MS300-180HDP	314	181	124	81	6.0	0.58	3.85	2.70	3	9.0	102	35	8.13
MS350-180HDP	367	181	124	85	7.0	0.79	4.51	3.30	4	9.0	90	35	8.13
MS330-215HDP	342	222	141	92	8.5	0.93	5.90	4.51	3	11.0	120	38	7.14
MS370-215HDP	380	218	141	90	9.0	1.07	6.30	4.60	4	11.0	90	38	7.14



Typ - MPS

No.	A (mm)	B (mm)	C (mm)	D (mm)	T (mm)	HDP (kg)	Nylon (kg)	PU (kg)	Pojemność (litry)		Średnica otworu			Options	max. pcs/m	
									Z2 (total)	Z3	No.	E (ø mm)	F (mm)			G (mm)
MPS80-80 HDP	90	85	63	43	4	0.08	0.09	0.10	0.24	0.20	2	9.0	43	18	R	15
MPS100-90 HDP	110	100	67	44	5	0.11	0.13	0.15	0.39	0.32	2	9.0	50	20	R	14
MPS120-100 HDP	129	110	80	55	5	0.15	0.18	0.20	0.61	0.48	2	9.0	67	25	R	12
MPS130-120 HDP	135	120	85	57	5	0.19	0.23	0.25	0.72	0.54	2	9.0	70	25	R	11
MPS140-120 HDP	145	120	90	62	5	0.18	0.22	0.24	0.81	0.62	2	9.0	70	25	R	10.8
MPS130-130 HDP	146	130	90	60	5	0.21	0.25	0.28	0.88	0.68	2	9.0	70	25	R	10.8
MPS160-140 HDP	172	152	113	78	6	0.34	0.40	0.45	1.55	1.25	2	9.0	100	30	R	8.6
MPS180-140 HDP	187	150	112	77	6	0.30	0.36	0.40	1.79	1.42	2	9.0	100	30	R	8.6
MPS200-150 HDP	205	150	112	75	6	0.35	0.42	0.46	1.89	1.39	2	9.0	100	32	R	8.6
MPS300-150 HDP	305	152	115	80	7	0.65	0.77	0.86	2.92	2.28	4	9.0	51-102-51	32	N-R	8.5
MPS200-160 HDP	210	158	115	79	7	0.39	0.46	0.51	2.09	1.77	2	9.0	100	32	R	8.5
MPS240-165 HDP	250	170	132	93	7	0.54	0.64	0.71	3.12	2.43	2	11.0	120	35	R	7.4
MPS280-165 HDP	293	170	132	95	7	0.67	0.79	0.88	3.75	3.06	3	11.0	80	36	N	7.4

Kubelki (czerpaki) ze stali

- ze stali tłoczanej w wersji ocynkowanej i nierdzewnej
- spawane

Typ - MPS

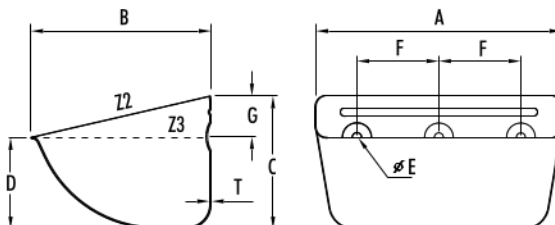

No.	T/Kg										Pojemność (litry)		Średnica otworu				
	A (mm)	B (mm)	C (mm)	D (mm)	1.0 (mm)	1.2 (mm)	1.5 (mm)	2.0 (mm)	2.5 (mm)	3.0 (mm)	Z2 (total)	Z3	No.	E (ø mm)	F (mm)	G (mm)	max. pcs/m
MPS80-80	85	80	58	39	0.11						0.21	0.18	2	8.0	43	16	15.0
MPS100-90	106	89	66	45	0.12		0.18			0.40	0.33	0.25	2	8.5	50	20	14.0
MPS100-100	105	97	78	46	0.18						0.42	0.29	2	8.5	50	25	12.0
MPS120-100	125	105	77	53	0.22		0.33				0.58	0.44	2	8.0	67	25	12.0
MPS140-110	146	112	91	40			0.43				0.76	0.41	2	8.5	70	25	10.5
MPS130-120	138	120	90	62		0.30	0.38				0.83	0.65	2	8.5	70	25	10.5
MPS140-120	146	120	90	62			0.40			0.80	0.87	0.65	2	8.5	70/86	25	10.5
MPS160-140	166	147	112	78			0.55			1.10	1.58	1.20	2	8.5	100	30	8.6
MPS180-140	187	147	112	78			0.61			1.22	1.75	1.35	2	8.5	100	30	8.6
MPS200-150	205	150	112	77			0.77			1.54	2.00	1.53	2	9.0	100/102	32	8.6
MPS230-160/A	233	160	122	85			0.86	1.15		1.72	2.72	2.05	3	9.0	70	32	8.0
MPS230-160/B	233	160	122	85			0.86	1.15		1.72	2.72	2.05	2	10.5	120	32	8.0
MPS240-160/A	247	165	130	92				1.35		2.00	3.03	2.37	3	10.5	70/77	35	7.4
MPS240-160/B	247	165	130	92				1.35		2.00	3.03	2.37	2	10.5	140	35	7.4
MPS240-160/C	247	165	130	92				1.35		2.00	3.03	2.37	2	10.5	120	35	7.4
MPS260-165	262	165	130	92				1.38		2.10	3.28	2.55	3	10.5	77/80	38	7.4
MPS280-165	289	167	132	93				1.55		2.32	3.78	2.95	3	10.5	80	38	7.4
MPS300-165/A	308	165	135	94				1.65		2.50	3.88	2.90	3	9.0	100/104	36	7.2
MPS300-165/B	308	165	135	94				1.65		2.50	3.88	2.90	3	11.0	100	36	7.2
MPS330-165	340	165	135	97				1.90		2.85	4.40	3.50	3	11.0	110/120	38	7.2
MPS350-165/A	360	165	135	94				2.12		3.20	4.50	3.65	4	9.0	90	38	7.2
MPS350-165/B	360	165	135	94				2.12		3.20	4.50	3.65	3	11	120	38	7.2

Typ - MS



No.								Pojemność (litry)		Średnica otworu			
	A (mm)	B (mm)	C (mm)	D (mm)	T (mm)	kg	Z2 (total)	Z3	No.	E (ø mm)	F (mm)	G (mm)	max. pcs/m
MS130-120	138	114	80	54	1.5	0.35	0.68	0.50	2	8.5	70	22	12
MS180-140	188	140	92	60	1.5	0.53	1.29	0.90	2	8.5	100	27	10.5
MS230-165	239	163	108	70	2.0	1.01	2.47	1.84	2	11.0	120	34	9
MS280-165	289	163	108	70	2.0	1.32	3.05	2.30	3	11.0	80	37	9
MS300-180	308	182	117	70	2.0	1.43	3.66	2.46	3	9.0	100	35	8.13
MS300-215	310	217	140	89	2.0	2.05	5.60	4.10	3	11.0	100	38	7.14
MS330-215/2.0	340	213	134	85	2.0	2.09	5.51	3.92	3	11.0	120	38	7.14
MS330-215/2.5	340	213	134	85	2.5	2.68	5.51	3.92	3	11.0	120	38	7.14
MS370-215/2.0	381	213	134	85	2.0	2.38	6.18	4.40	4	11.0	90	38	7.14
MS370-215/2.5	381	213	134	85	2.5	2.98	6.18	4.40	4	11.0	90	38	7.14
MS450-215	464	213	134	85	2.5	3.40	8.00	5.59	5	11.0	90	38	7.14